



CONRAD®
NEW YORK

the luxury of being yourself™



Location

Conrad New York
102 North End Avenue
New York, New York, United States, 10282
Tel: [1] 212-945-0100 Fax: [1] 212-945-3012
ConradNYSales@Hilton.com
ConradHotels.com
ConradMeetings.com

Conrad New York

The Conrad New York puts a fresh perspective on New York City's historic Financial District, with contemporary luxury on full display in 463 superbly appointed guest rooms and magnificent views of the Hudson River and beyond. Scheduled to open in late 2011, Conrad New York is convenient to all of downtown Manhattan's most notable landmarks and attractions, including the World Financial Center, New York Stock Exchange, City Hall, Trinity Church, the World Trade Center, South Street Seaport and Battery Park. The neighborhoods of TriBeCa, SoHo, Greenwich Village and the Meatpacking District are also just minutes away.





Guestroom Information

The Conrad New York entices with a new standard of contemporary luxury to appeal to savvy business and leisure travelers alike. Designed by a diversely talented team of architects and designers, the hotel features 463 guest rooms arrayed for spaciousness and comfort, with an average size of over 420 square-feet (39 square meters). Thoughtful design, superb finishing, convenient one-touch technologies, and unparalleled in-room amenities come together in the hotel's deluxe accommodations to create elegant retreats for business engagements or for simply relaxing at the end of an "only-in-New York" day.

Room Amenities

- Separate areas for sleep and work
- Custom furnishings
- Spacious layout
- Walk-in shower
- Separate dressing area
- Linen thread count of 300
- In-room iPod sound dock
- Mini-bar
- Wireless internet access
- Daily newspaper
- Nightly turn-down service
- Two large flat screen televisions





Hotel Features

- Fourteen floors of spacious guestrooms that are suited for both business and leisure
- Over 30,000 square feet / 2,787 square meters of meeting space including a 6,288 square foot / 584 square meters Gallery Ballroom designed for gatherings of up to 580 guests
- Twenty-six guestrooms that can be converted into 1:1 meeting space
- 24-hour Fitness Center
- Seasonal Rooftop Terrace providing 360° views of the New York City skyline and Hudson River
- Superior selection of dining options
- Early check-in and late check-out on request (subject to availability)
- Pre-registration and express check-out
- Expected Leadership in Energy and Environmental Design (LEED) Gold Certification
- Valet service and convenient nearby self-parking

Design

In a city that knows design, the Conrad New York stands out with striking contemporary interiors styled through a collaborative effort among innovative architects and sought-after interior designers. Josh Chaiken of KPF Associates, Monica Ponce de Leon of MPdL Studios, Jill Greaves of Jill Greaves Design, Ken Smith of Ken Smith Landscape Architect, Marianne McKenna of KPMB Architects, Herve Descottes of L'Observatoire, and David Cooper of Flack & Kurtz were among those firms that signed on to fashion an eye-catching interior that captivates guests from the moment they arrive. An onsite art program showcases contemporary works selected by the Public Art Fund by artists including Sol LeWitt, Mary Heilmann, Elizabeth Peyton, Pat Steir, and Sara Sosnowy.





Dining and Retail on Site

- All day dining available at the Conrad New York hotel restaurant, Atrio
- Seasonal Rooftop Terrace
- Atrium Lounge and Coffee Bar
- 24-hour room service
- Second floor barbershop

Adjacent Dining

- Three restaurants by renowned restaurateur Danny Meyer: Blue Smoke, Shake Shack, and North End Grill
- Harry's Italian – part of Peter Poulakakos's expanding restaurant group, offering award-winning Italian specialties and a vibrant wine bar
- Many other restaurants and retail shops including Accents New York, Battery Place Market, Greens & Beans, Francois Payard Bakery, Vintry Wines, Wei West, Bloom, and Artsee Eyewear





Conference & Meeting Facilities

Thoughtful style, contemporary design and cutting edge technology provide the perfect environment for gatherings both business and social. Over 30,000 square feet of event space combine to offer a centralized location for meetings and events that range from 10 to over 500 people. Board Meetings to Gala Events, the Conrad New York is the newest addition to the Lower Manhattan event market place. Open-spaced foyer areas, rooms bathed in daylight, high ceilings all centrally located on two floors provide an ideal flow for attendees. Our dedicated meeting concierge staff provides service that is anticipatory and sophisticated. In partnership with Union Square Events, a Danny Meyer company, the Conrad New York is the perfect choice.

Conference Features

- Over 30,000 square feet of thoughtfully designed meeting space
- Gallery Ballroom boasts over 6,200 square feet

Conference Center – 2nd Floor Atrium Level

KEY

- BALLROOMS / MEETING ROOMS
- FOYER / CIRCULATION
- RESTROOMS
- STAIRS



Conference Center – 2nd Floor Atrium Level

MEETING ROOM	TOTAL SQ FT	WIDTH x LENGTH	HEIGHT	SET UP						
				BANQUET	RECEPTION	CLASSROOM	THEATER	CONFERENCE	HOLLOW SQUARE	U-SHAPE
West Ballroom	3,445'	40' x 86'	12'	300	350	225	410		100	80
Section A	1,148'	41' x 28'	12'	95	130	70	130	34	40	30
Section B	1,148'	41' x 28'	12'	95	130	70	130	34	40	30
Section C	1,148'	41' x 28'	12'	95	130	70	130	34	40	30
Combination A & B	2,296'	41' x 56'	12'	190	260	140	260	50	70	60
Combination B & C	2,296'	41' x 56'	12'	190	260	140	260	50	70	60
West Foyer	5,863'				245					
Boardroom	902'	38' x 24'	13'					18		
Studio One	577'	24' x 24'	13'	50	80	45	70	24	26	20
Studio Two	531	22' x 24'	13'	40	60	35	55	20	24	14
Studio Three	608'	25' x 24'	13'	40	60	35	55	20	24	14
Studio Four	608'	25' x 24'	13'	40	60	35	55	20	24	14
Studio Three & Four	1,216'	25' x 48'	13'	90	110	70	100	40	44	30
Studio Five	581'	24' x 24'	13'	40	60	35	55	20	24	14
Studio Six	1,276'	27' x 48'	13'	90	120	40	110	40	44	30

Conference Center – 4th Floor

KEY

- BALLROOMS / MEETING ROOMS
- FOYER / CIRCULATION
- RESTROOMS
- STAIRS

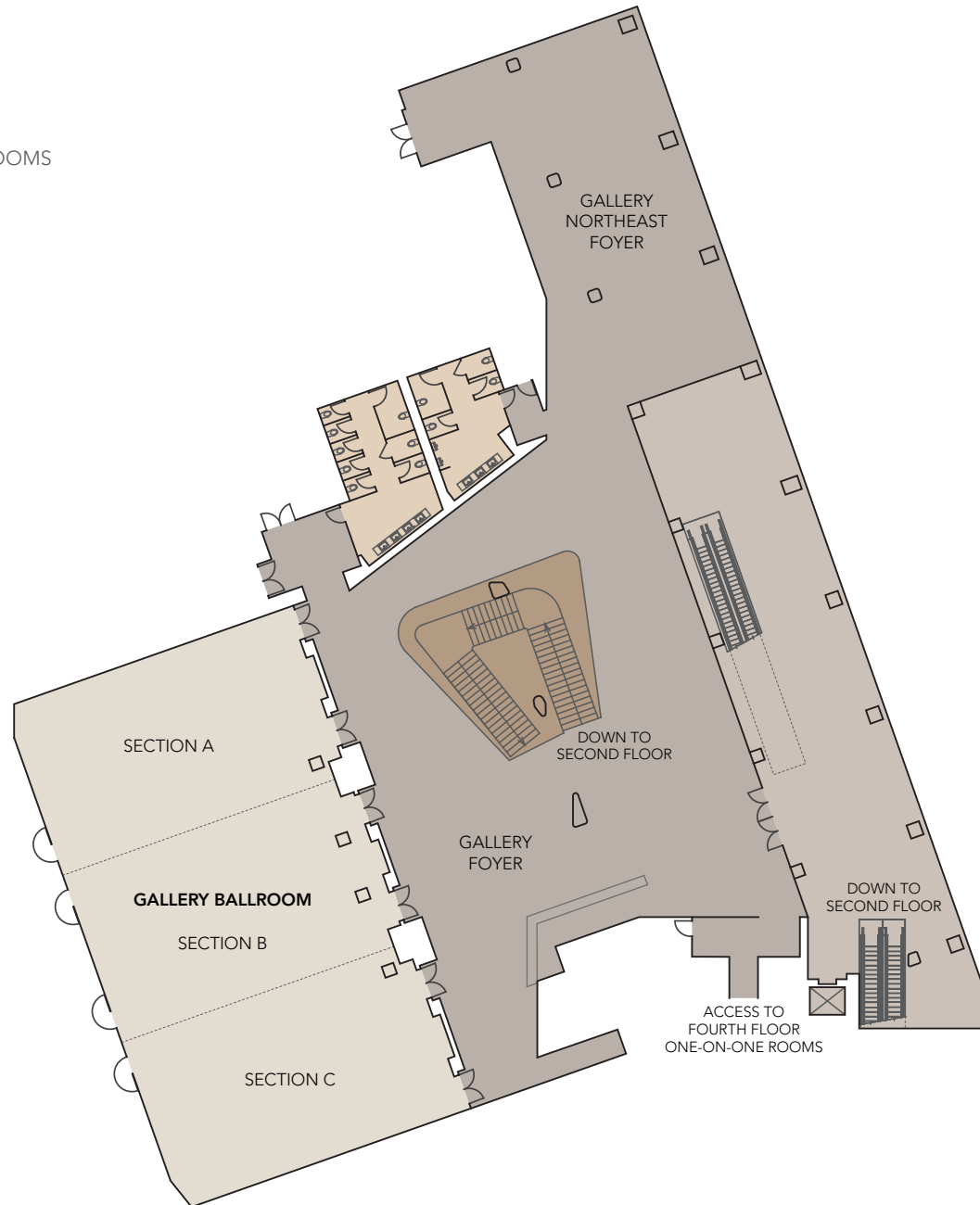

Conference Center – 4th Floor

MEETING ROOM	TOTAL SQ FT	WIDTH x LENGTH	HEIGHT	SET UP					
				BANQUET	RECEPTION	CLASSROOM	THEATER	HOLLOW SQUARE	U-SHAPE
Gallery Ballroom	6,288'	60' x 104'	19'	520	560	375	560	140	125
Section A	2,096'	35' x 60'	19'	170	225	130	215	65	55
Section B	2,096'	35' x 60'	19'	170	225	130	215	65	55
Section C	2,096'	35' x 60'	19'	170	225	130	215	65	55
Combination A & B	4,192'	70' x 60'	19'	340	450	250	430	110	90
Combination B & C	4,192'	70' x 60'	19'	340	450	250	430	110	90
Gallery Foyer	6,659'				210				
Gallery Foyer Northeast	2,730'				105				